

Morwenstow Parish Council

Health & Wellbeing Project



Comprising of:

- * Multi—Use Games Area
- * Multi—Use Pump Track to cater for bikes, bmx's, scooters, skateboards & roller skating
- * Outdoor Fitness Equipment stations

Mission:

To improve general health and wellbeing within the Parish of Morwenstow by enhancing the outdoor facilities at Morwenstow Community Centre.

This comprises of three elements – adult exercise facilities, children’s (and adults) skate/bike facilities and an all weather sporting facility to aid the existing successful football club, including use for all members of the community.

This vision also incorporates the addition of a power supply to provide the facility of electric vehicle charging.

Multi Use Games Area:

Size: 42m x 33m—Accommodation for general play/ training and league matches for Under 7's & Under 8's football teams.

Surface: 3G using 50mm pile height synthetic turf

Cost: Approx—£200,000.00

Area: Current training pitch to be used in its entirety to accommodate this.

Funding avenues: Community Levelling Up Programme
Football Foundation
Fund-raising
Others to be explored

Proposed MUGA Area
Outlined in Green

Legend

- EX23 9SL
- Feature 1



Google Earth

40 m



Image for illustration purposes only – please pay no attention to the sizes.

LINE MARKINGS

SPORT	COLOUR	WIDTH
TENNIS	WHITE	50mm
BASKETBALL	BLUE	50mm
5v5 FOOTBALL	YELLOW	50mm
NETBALL	RED	50mm



3m high twin bar sports rebound panel system 868 fencing in RAL 6005

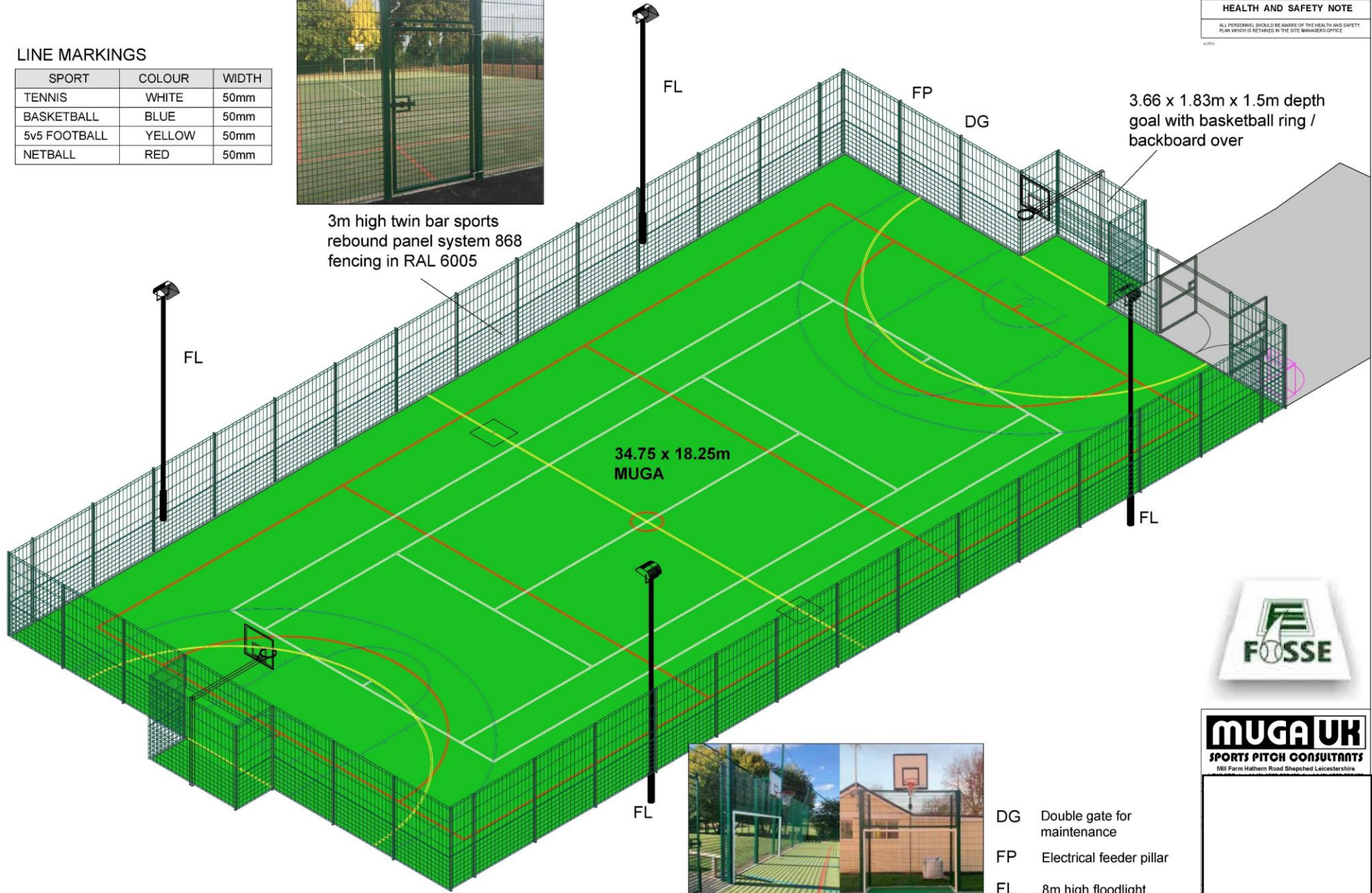

3.66 x 1.83m x 1.5m depth goal with basketball ring / backboard over

34.75 x 18.25m MUGA

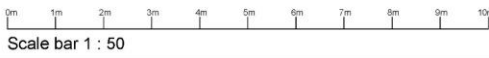

1- ALL DIMENSIONS TO BE CHECKED ON SITE PRIOR TO COMMENCEMENT OF WORKS
 2- THE DRAWINGS IS COPYRIGHT. THIS DRAWING AND DESIGN MUST NOT BE COPIED OR USED WITHOUT THE EXPRESS CONSENT OF MUGA UK LTD
 3- ALL PERSONNEL SHOULD BE AWARE OF THE HEALTH AND SAFETY PLAN WHICH IS RETAINED IN THE SITE MANAGERS OFFICE

HEALTH AND SAFETY NOTE

ALL PERSONNEL SHOULD BE AWARE OF THE HEALTH AND SAFETY PLAN WHICH IS RETAINED IN THE SITE MANAGERS OFFICE.



- DG Double gate for maintenance
- FP Electrical feeder pillar
- FL 8m high floodlight column

Multi Use Pump Track:

To cater for Bikes, BMX's, Scooters, Skateboards & Roller Skating.

Size: Approximately 150 metres long & 2 metres wide

Surface: Asphalt

Cost: Ballpark—£50,000.00

Area: Space below the current training pitch.

Funding Avenues: Community Levelling Up Fund.

Proposed PUMP TRACK Area

Outlined in Red

Legend

- EX23 9SL
- Feature 1

EX23 9SL



A potential design...

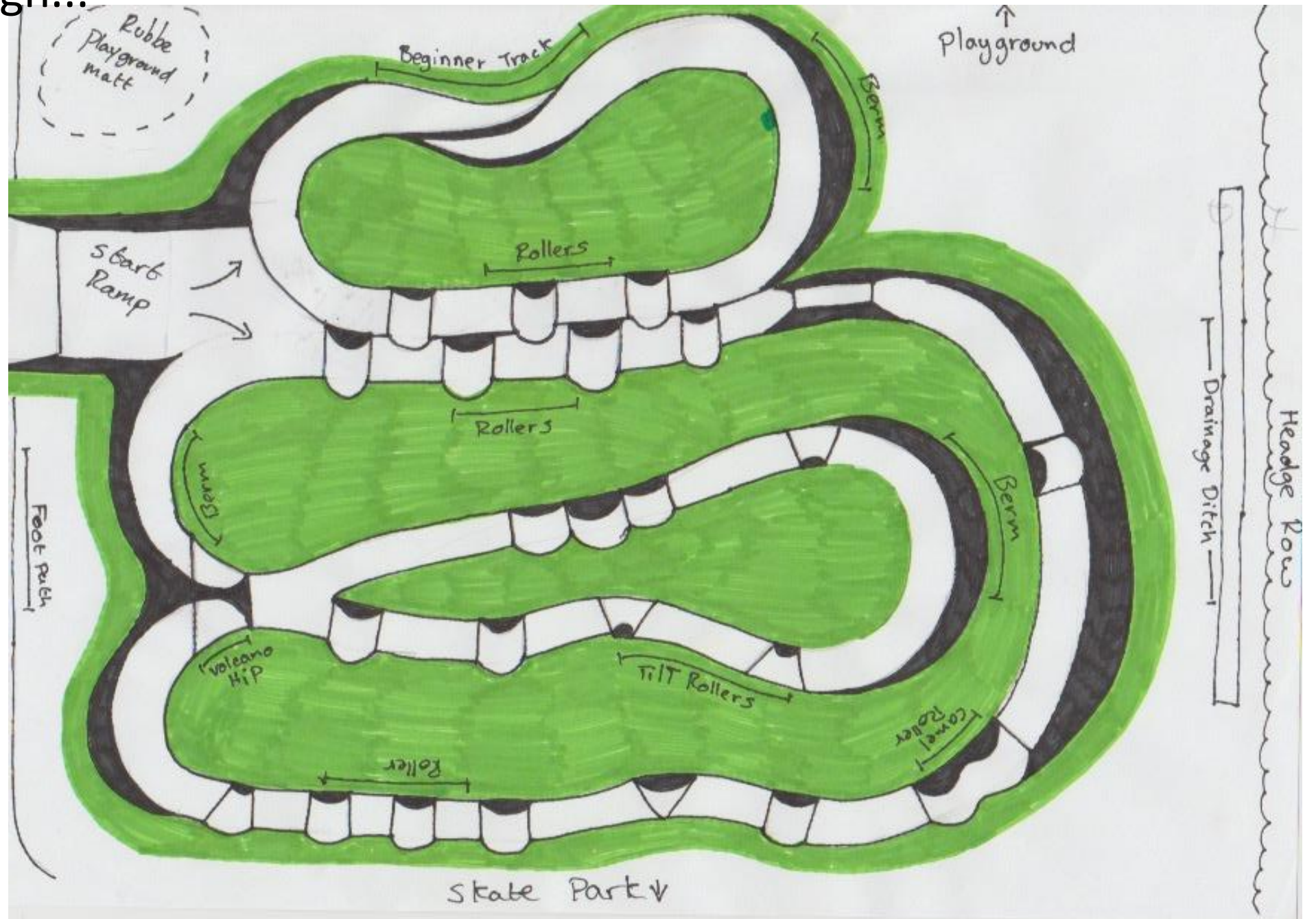

Another potential design...

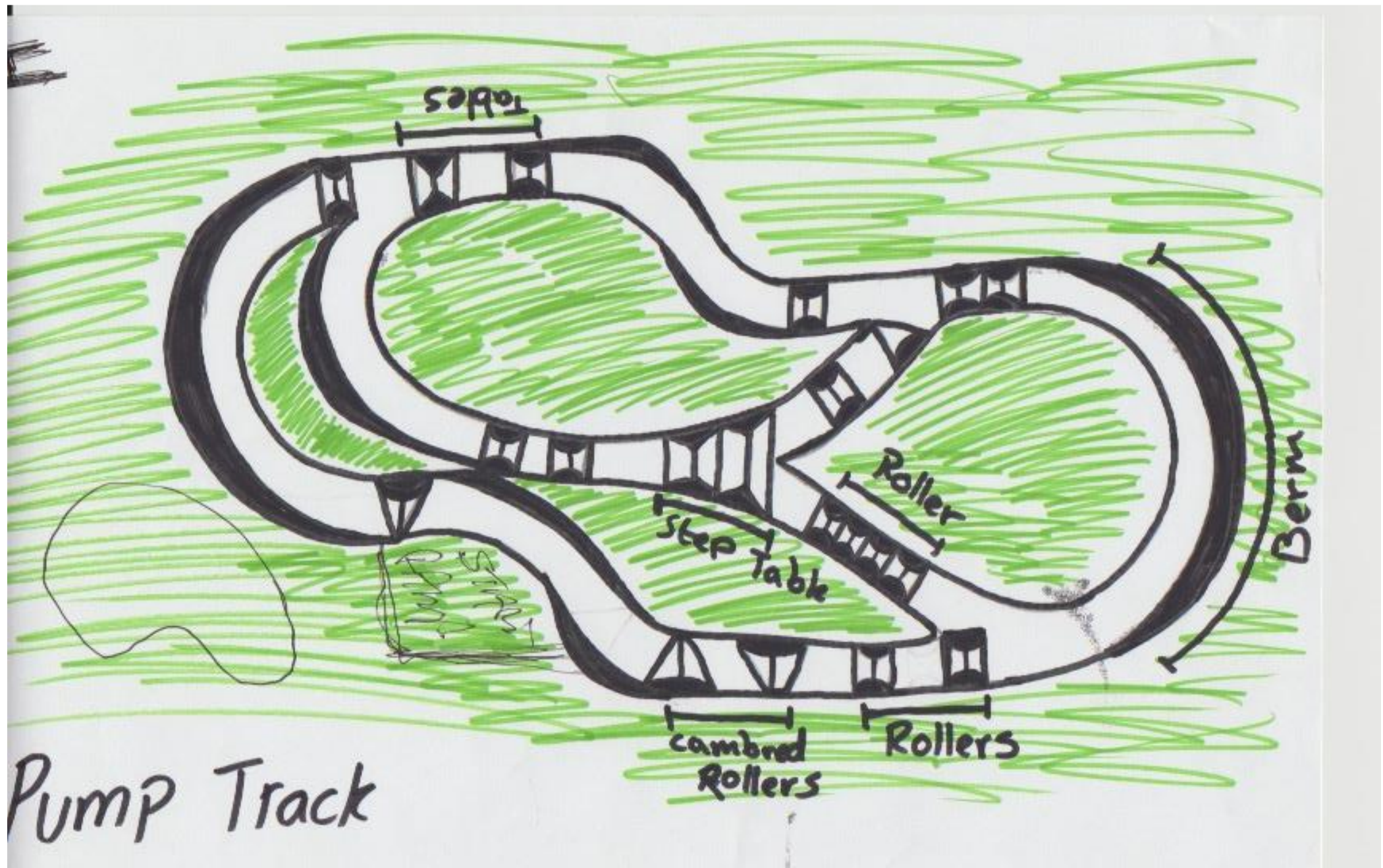

Pump Track

Community Fitness Suite:

Size:	Eight stations
Surface:	Can go straight onto grass with rubber matting installed
Cost:	£11,353.00 + VAT
Area:	Space beside the Community Centre adjacent to the existing play equipment.
Funding Avenues:	Community Levelling Up Fund

Proposed FITNESS SUITE Area

Outlined in pink

Legend

- EX23 9SL
- Feature 1



